

# Premium Booth 6mW x 3mD Left Corner Booth

HT-A-18\_L-Cnr  
6mW x 3mD x 3.5mH

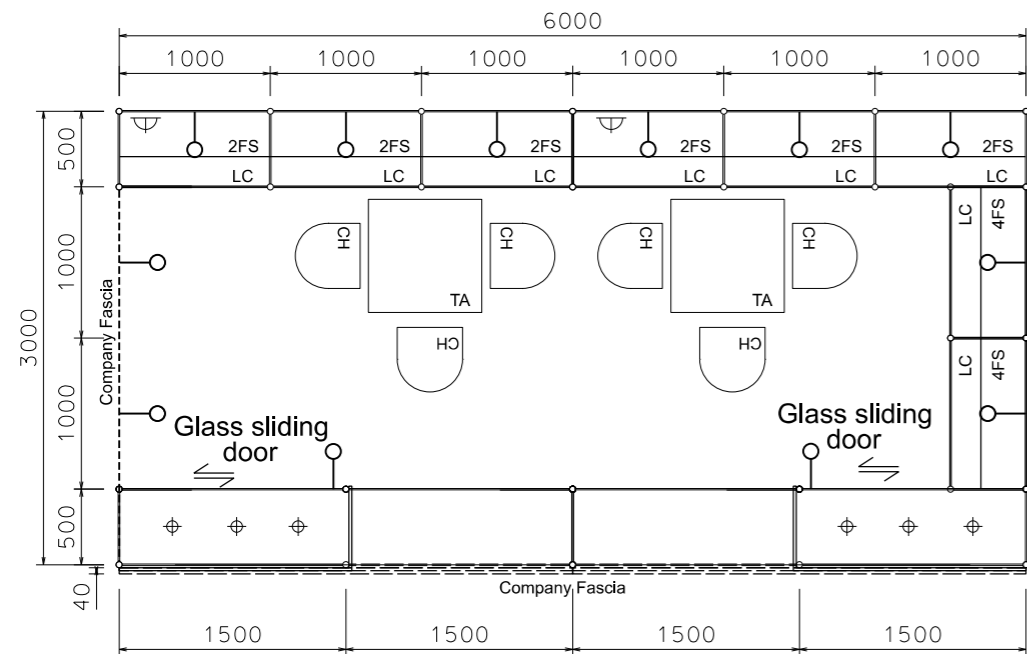

PLAN

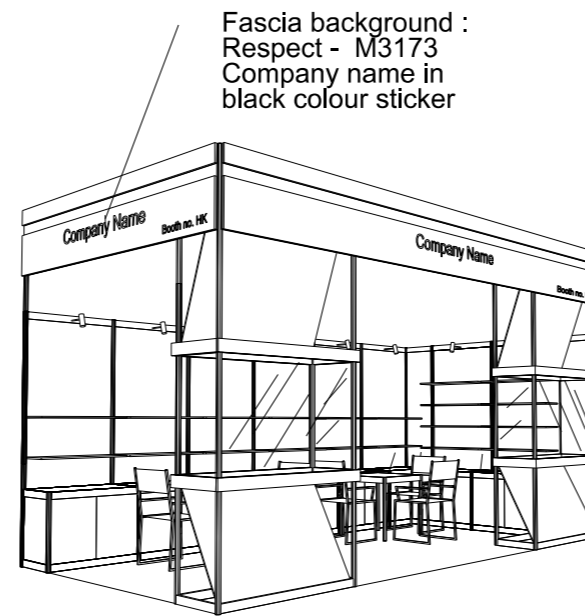

PERSPECTIVE N.T.S

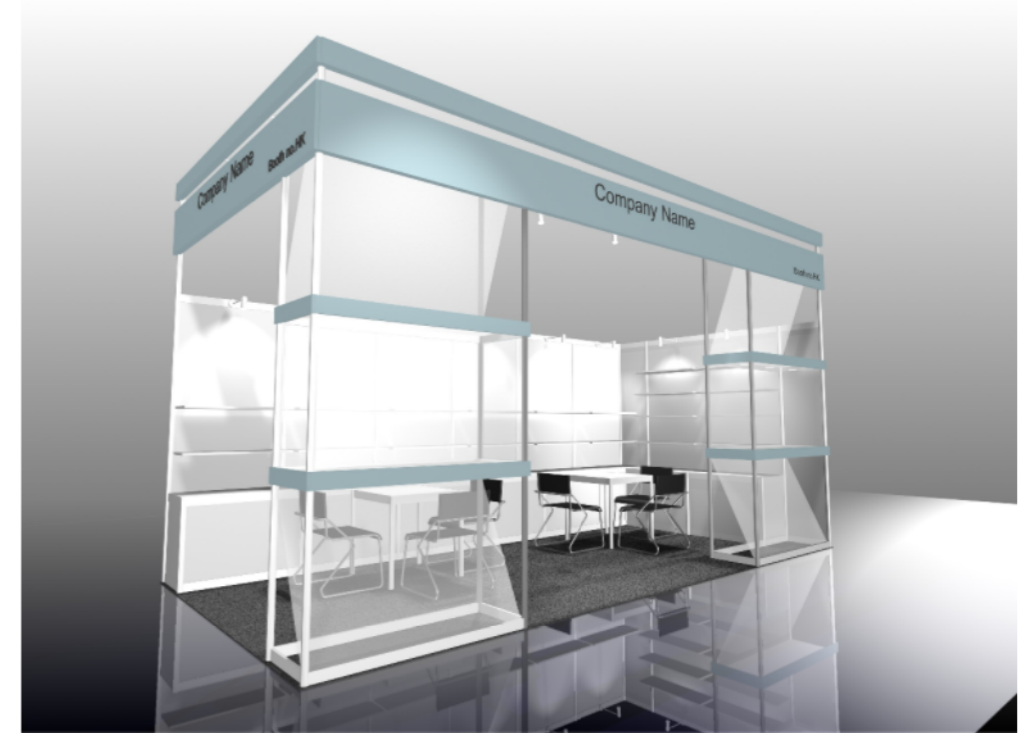

COLOUR PERSPECTIVE N.T.S

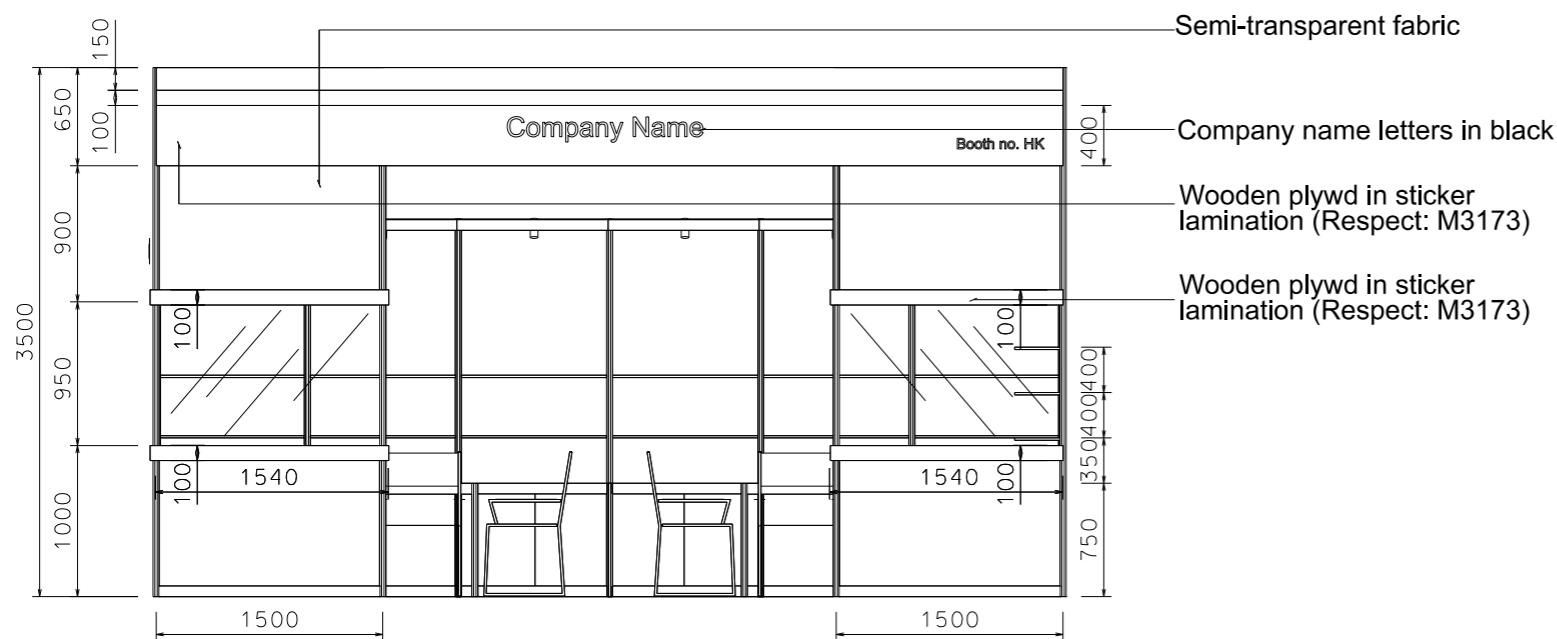

FRONT ELEVATION

BOOTH SPECIFICATION		QTY
	Front glass showcase w/ glass sliding door (1.5mW x 0.5mD x 0.95mH) and 3 x (7W) LED downlights	2
	Lockable cabinet (1mL x 0.5mD x 0.75mH)	8
	Wooden flat shelf (1mW x 0.3mD)	20
	Square meeting table (0.7m X 0.7m x 0.75mH)	2
	Black leather chair	6
	Longarmed spotlight w/13 watt LED lamp (yellow)	12
	500w Square pin power socket *Remark: Not Applicable for heating equipment (eg. Coffee machine)	2

FILE PATH - L:\Local Fair Premium Booth 2011\Hometextile\HT A\HT-A-2dLayout\_2013.dgn



NOTES UNLESS OTHERWISE SPECIFIED ALL DIMENSIONS ARE IN MM.

.....  
.....  
.....

.....  
.....  
.....

REVISION  
03/04/2013  
21/05/2013  
07/06/2013  
12/12/2019  
12-04-2022

DATE: 12-12-2019  
SCALE: 1 : 50 (A3)  
DRAWN BY: ..  
CHECKED BY: .....

TITLE  
Premium Booth  
HT-A-18  
Left Side Corner

PROJECT  
HONG KONG INTERNATIONAL  
HOME TEXTILES AND  
FURNISHINGS FAIR  
PREMIUM BOOTH  
6m x 3m  
DATE: XXXXXXXX

SHEET  
HT-A02b