

Premium Booth 6mW x 3mD Right Corner Booth

HT-A-18_R-Cnr
6mW x 3mD x 3.5mH

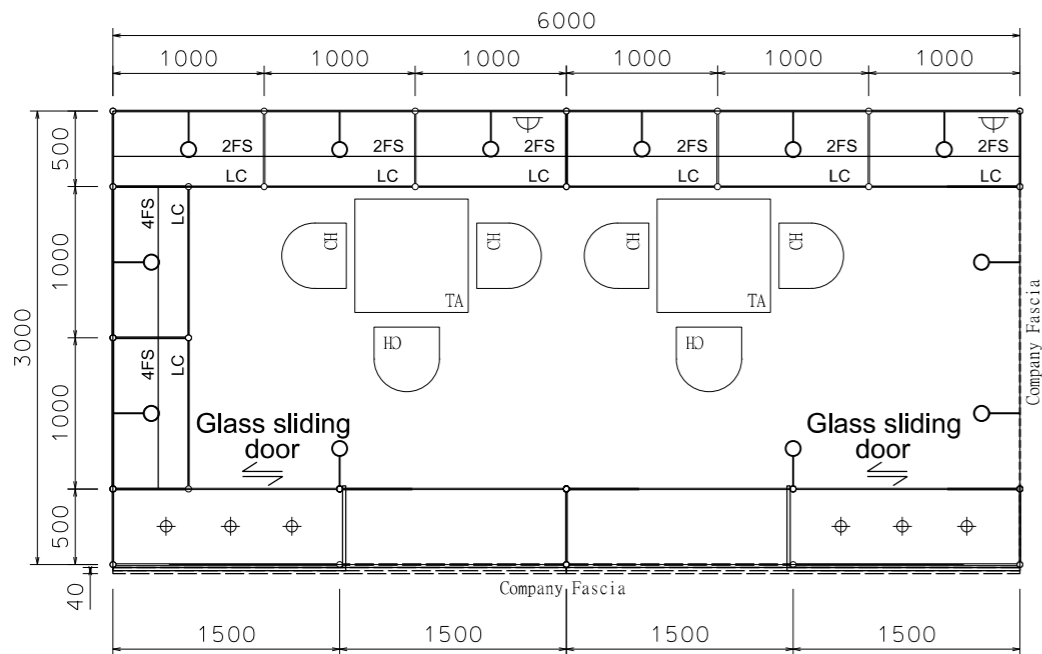

PLAN

Fascia background :
Respect - M3173
Company name in
black colour sticker

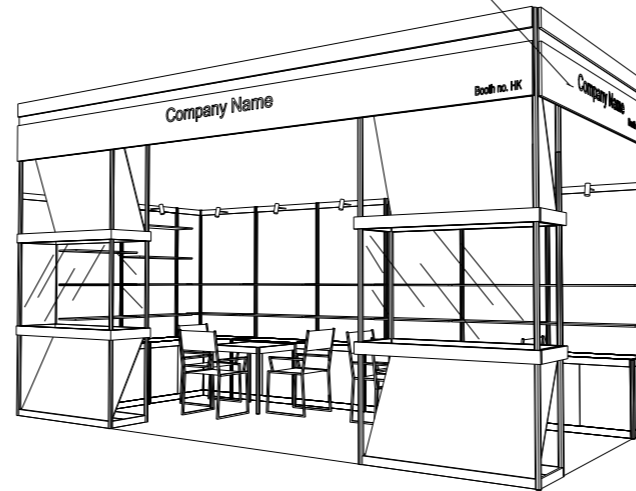

PERSPECTIVE N.T.S

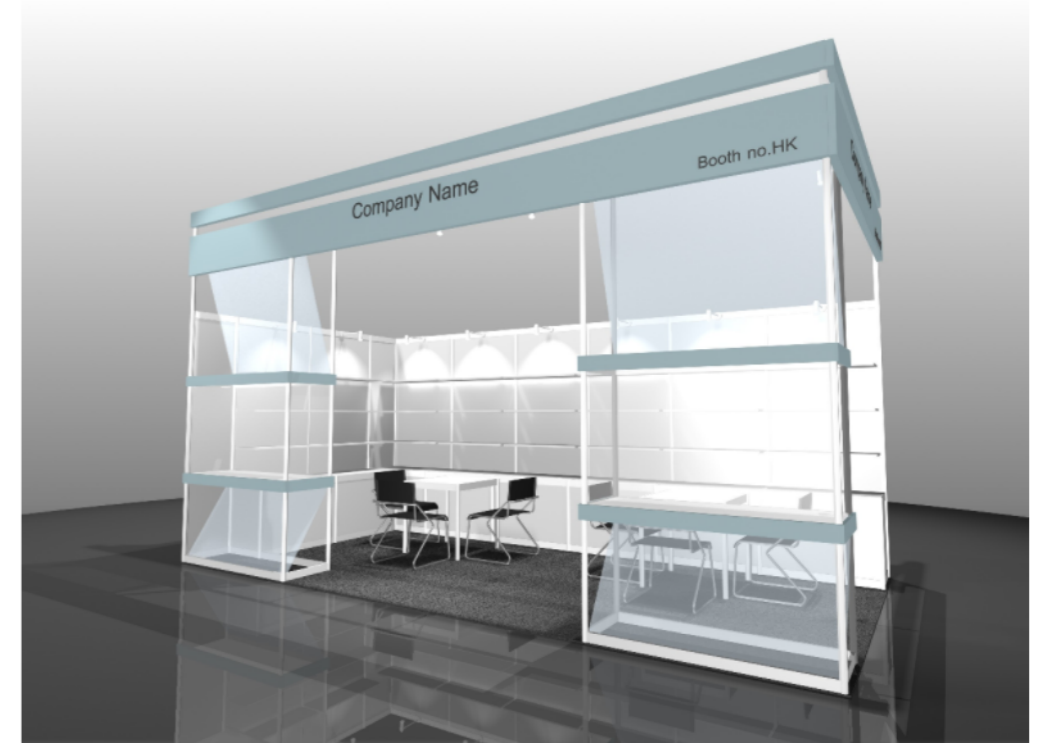

COLOUR PERSPECTIVE N.T.S

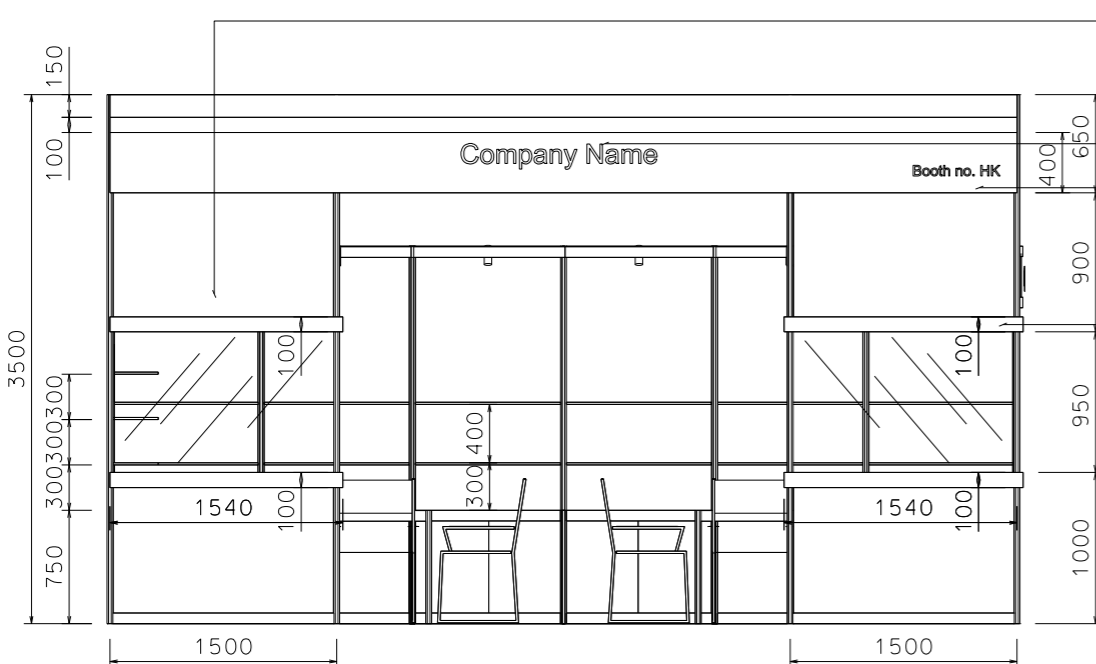

FRONT ELEVATION

Semi-transparent fabric

Company name letters in black

Wooden plywd in sticker lamination (Respect: M3173)

Wooden plywd in sticker lamination (Respect: M3173)

BOOTH SPECIFICATION		QTY
	Front glass showcase w/ glass sliding door (1.5mW x 0.5mD x 0.95mH) and 3 x (7W) LED downlights	2
	Lockable cabinet (1mL x 0.5mD x 0.75mH)	8
	Wooden flat shelf (1mW x 0.3mD)	20
	Square meeting table (0.7m X 0.7m x 0.75mH)	2
	Black leather chair	6
	Longarmed spotlight w/13 watt LED lamp (yellow)	12
	500w Square pin power socket *Remark: Not Applicable for heating equipment (eg. Coffee machine)	2

FILE PATH - L:\Local Fair Premium Booth 2011\Hometextile\HT-A-18\A-2dLayout_2013.dgn



NOTES UNLESS OTHERWISE SPECIFIED ALL DIMENSIONS ARE IN MM.

.....
.....
.....

.....
.....
.....

REVISION

20-03-2009
31-03-2009
02-04-2009
03-07-2009
08-07-2009
29-12-2009
21-05-2013
07-06-2013
12-12-2019
12-04-2022

DATE: 12-12-2019

SCALE: 1 : 50 (A3)

DRAWN BY: ..

CHECKED BY:

TITLE

Premium Booth
HT-A-18
Right Side Corner

PROJECT

HONG KONG INTERNATIONAL HOME TEXTILES AND FURNISHINGS FAIR PREMIUM BOOTH
6m x 3m
DATE: XXXXXXXX

SHEET

HT-A02a